

Interal T.C. bv



60

PROTRUSS CATALOG

## Protruss 60.

The P60 was specially developed for heavy duty applications - for stage applications, and rentals. The P60 truss is available in rectangular. Due to its slender shape, the rectangular model is also much in demand for applications in which the visual image generated plays an important role. The rectangular truss is also ideal from a logistics viewpoint (for storage as well as transport).

technical specifications protruss	
Type	60 R
Alloy	51 st. AlMgSi 1 F 31 ISO Standard AlMgSi EN-AW 6082 T6
Tube	Ø 50 x 4 mm
Brace	Ø 30 x 3 mm
End brace	Ø 50 x 4 mm
Connection	Alu. connection piece with spigot and R-spring

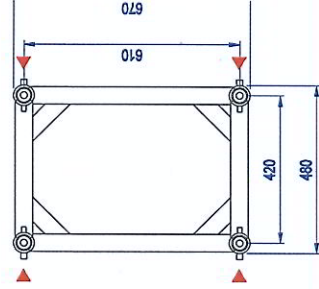

P 60 R

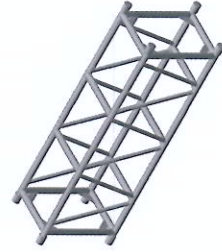

P 60 R

The conical connection pieces (large size) allow quick and easy assembly, practically without the use of tools. Internal produces a large assortment of connectors, arches, circles and special constructions based on the Protruss 60 series.

The conical connection piece allows you to assemble your system in the shortest of time.

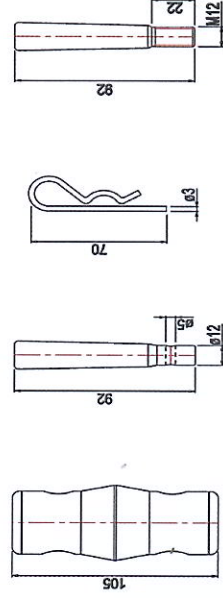

605011

605012

605013

605015



description  
connection pieces

Protruss 60 SERIES	TUBE - Ø 50 X 4				
Standard Lengths (m)	0,50	1,00	1,50	2,00	3,00
60R (kg)	10	17	26	34	51

## PROTRUSS P60R

## TUBE - Ø 50 X 4

	2	3	4	5	6	7	8	9	10	11	12	13	14
Length (M)													
Point Load (Kg)	5689	5672	5044	4019	3334	2842	2471	2180	1946	1753	1590	1452	1331
2 Point Load (Kg at ¼, ½ and ¾)	2844	2836	2827	2819	2501	2131	1853	1635	1459	1315	1193	1089	999
3 Point Load (Kg at ¼, ½ and ¾)	1896	1891	1885	1879	1667	1421	1235	1090	973	876	795	726	666
4 Point Load (Kg at ¼, ½ and ¾)	1422	1418	1414	1409	1384	1179	1025	905	808	727	660	602	553
Uniformly Distributed load (Kg/M)	2845	1891	1414	1128	937	801	618	484	389	319	265	223	190
Uniformly Distributed Load (Kg)	5690	5673	5656	5640	5622	5607	4944	4356	3890	3509	3180	2899	2660

## PROTRUSS P60R

## TUBE - Ø 50 X 4

	15	16	17	18	19	20	21	22	23	24
Length (M)										
Point Load (Kg)	1226	1133	1050	975	907	845	788	736	687	642
2 Point Load (Kg at ¼, ½ and ¾)	920	850	787	731	680	634	591	552	515	481
3 Point Load (Kg at ¼, ½ and ¾)	613	567	525	488	454	423	391	368	344	321
4 Point Load (Kg at ¼, ½ and ¾)	509	470	436	405	376	351	327	305	285	266
Uniformly Distributed load (Kg/M)	164	142	124	108	96	85	75	67	60	54
Uniformly Distributed Load (Kg)	2460	2272	2108	1944	1824	1700	1575	1474	1380	1296

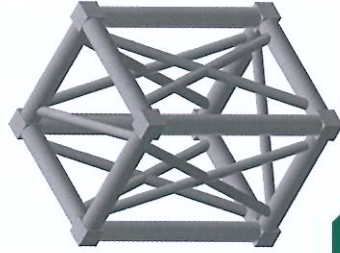

description

Boxcorner P60R



description

Rack P60R

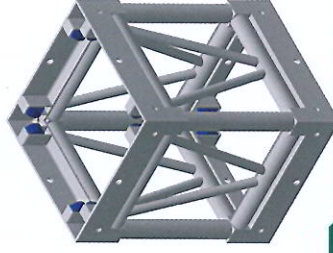

description

Sleeveblock P60R/P50 for Tower 2000

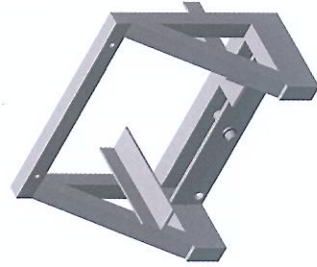

description

Attachment for Electric climbing hoist



NO PART OF THIS CATALOG, INCLUDING THE PRODUCTS DESCRIBED IN IT, MAY BE REPRODUCED, TRANSMITTED, TRANSCRIBED, STORED IN A RETRIEVAL SYSTEM, OR TRANSLATED INTO ANY LANGUAGE FORM OR BY ANY MEANS, WITHOUT THE EXPRESS WRITTEN PERMISSION OF INTERNAL T.C. BV.

SPECIFICATIONS AND INFORMATION CONTAINED IN THIS CATALOG ARE FURNISHED FOR INFORMATIONAL USE ONLY, AND ARE SUBJECT TO CHANGE AT ANY TIME WITHOUT NOTICE, AND SHOULD NOT BE CONSTRUED AS A COMMITMENT BY INTERNAL T.C. BV.

INTERNAL T.C. BV ASSUMES NO RESPONSIBILITY OR LIABILITY FOR ANY ERRORS OR INACCURACIES THAT MAY APPEAR IN THIS CATALOG, INCLUDING THE PRODUCTS DESCRIBED IN IT.



# Internal T.C. bv

Maasheseweg 73  
NL 5804 AB  
Venray  
Netherlands

t. +31 (0)478 542 018  
f. +31 (0)478 542 109  
e. [info@internal.nl](mailto:info@internal.nl)  
w. [www.internal.nl](http://www.internal.nl)

